



PC3019F

Gigabit PoE Media Converter

This Rugged 30 Watts Industrial POE converter is designed with hardened Marvell IC, It delivers 30Watts POE power and can tolerate extreme temperature in a harsh environment. Our ColdDesign technology will not only power up your PD device, also reduce the excessive heat problem to a minimum. It accepts the input voltage from 48VDC to 56VDC to meet IEEE802.3af/at required voltage. It is being rigorously tested for your Security, Transportation and Telco application.

Dimension:

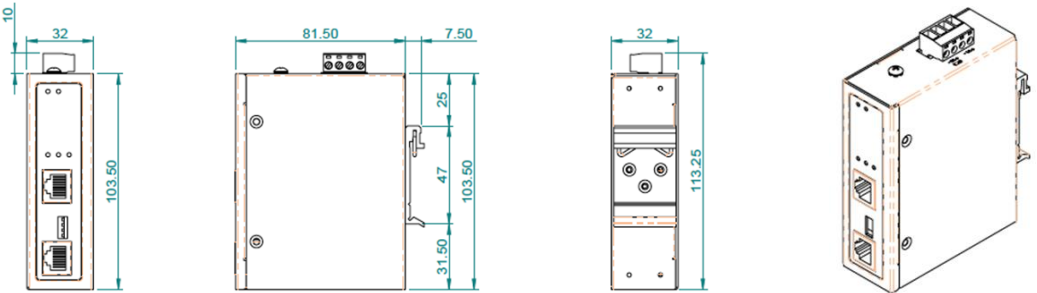

- ▶ Industrial 30W Hardened Gigabit POE converter
- ▶ Designed with hardened Marvell IC
- ▶ 1x10/100/1000M 30W PSE (supports 802.3af/at) TX + 100/1000M SFP,
- ▶ 48-56VDC, Operating temp: -40°C to +75°C

Technical Specifications

Gigabit PoE Media Converter

Model#
PC3019F

IEEE Standard
IEEE 802.3 10Base-T Ethernet
IEEE 802.3u 100Base-TX Fast Ethernet
IEEE 802.3ab 1000Base-T Gigabit Ethernet
IEEE 802.3z 1000Base-X Gigabit Ethernet
IEEE802.3af for POE
IEEE802.3at for POE+

Switch Architecture
Back-plane (Switching Fabric): 4Gbps

Data Processing / Installation
Store and Forward / DIN Rail mounting and Wall Mounting

Flow Control / Jumbo Frame / MAC address table size
IEEE 802.3x Flow Control and Back Pressure / 9KB / 2K

MTBF (mean time between failure)
510,304 hrs (MIL-HDBK-217F) at 25°C

Packet buffer size / Protocol
1 M / CSMA/CD

Network connector
1xRJ-45 10/100/1000BaseT(X) PSE with PoE
Output power up to 36Watts
1 x 100/1000M SFP

Network Cable
UTP/STP above Cat.5e Cable
EIA/TIA-568 10-ohm (100m)

Housing
Rugged Metal ,IP30 Protection

LED
PW1(power 1) Green: ON- power good, OFF-power failed
UTP LED: Amber ON - PD detected / Green ON – Link/active
SFP LED: Green ON – SFP detected

PoE Pin Assignment
30 watts 2 pairs Mode A End Span / V+, V+, V-, V- for pin 1, 2, 3, 6

DIP switch / Case Dimension (L X W X D)
To select SFP speed 100M or 1000M / 103.5mmx32mmx81.5mm

Reverse polarity protection / Overload current protection
Present

Power Supply
4 pin terminal block with 48V-56V VDC Power Input, SW (Relay): Relay switch for alarm

Alarm Relay Contact
Relay outputs with current carrying capacity of 1 A @24VDC, Relay in short circuit mode when power fails. in open circuit mode when power supply is connected

Power consumption / POE power
2 W@48 VDC Without POE / Maximum POE power 36watts at 56VDC input

Removable terminal block
Provide 4 pin terminal block / Wire range: 0.34mm ² to 2.5mm ²
Solid wire (AWG):12-24/14-22 / Stranded wire(AWG): 12-24/14-22
Torque:5lb-In/0.5Nm/0.56Nm / Wire Strip length: 7-8mm

Operating Temperature / Operating Humidity / Storage Temperature
-40°C ~ 75°C fully tested / 5% to 95% (Non-condensing) / -40°C ~ 85°C

Certifications	
EN55022/24	ITE equipment
EN55011	Industrial, Scientific and Medical (ISM) equipment
Safety	IEC EN60950-1
EMC/EMS	CE, FCC, VCCI
EMI	FCC Part 15 Subpart B Class A, CE EN 55022 Class A
EN 50155 / EN 60068-2-6	Vibration
EN 50155 / EN 60068-2-27	Shock
EN 50155 / EN 60068-2-32	Free Fall